



FEATURES

- ▼ Corrosion resistant copper-free marine-grade aluminum housing with an oven-cured polyester powder coated white high gloss protective finish.
- ▼ Lamp options in 2 x 17, 20, 24, 32, 40 and 54w fixtures.
- ▼ High impact protective wire guard available.
- ▼ Rated for operation on 120v AC 60Hz as standard. Other voltages optional.
- ▼ Supplied with a wrap around high impact extruded acrylic lens gives even uniform light distribution.
- ▼ Emergency fixtures available.
- ▼ 5 year warranty.

APPROVALS

- ▼ UL 1598A - Marine Inside Drip Proof Type
- ▼ UL 924 - Emergency Lighting Equipment
- ▼ ABS
- ▼ Conforms to IP 52

APPLICATIONS

- ▼ Marine and wet environments
- ▼ Offshore oil and gas platforms
- ▼ Drill ships and exploration vessels
- ▼ Tankers
- ▼ Cabin and Hallway lighting

OPTIONS

To obtain a fixture with any of the options listed below, please add the following suffix to the part number (not all options can be combined):

- | | |
|---------------------------------|-------|
| ▼ Frosted White Lens | E |
| ▼ Red Filter Tube (one) | RV* |
| ▼ Low Temperature Rated Fixture | /0DEG |
| ▼ Emergency Ballast | EM |
| ▼ Guard | GRD |
| ▼ 220v 50Hz | -225 |
| ▼ 220v 60Hz | -226 |
| ▼ 270v 60Hz | -276 |

* Not available in 24w or 54w.

DIMENSIONS

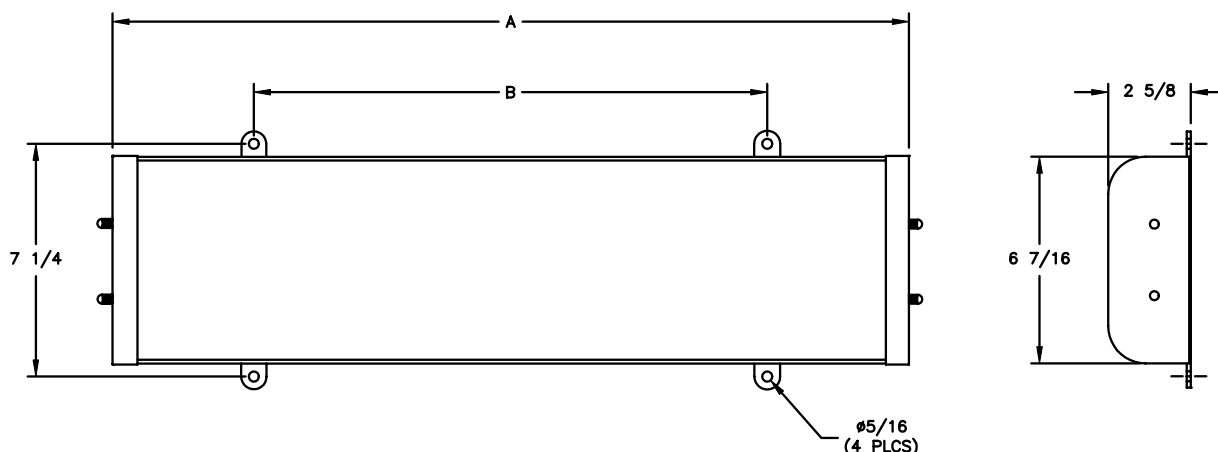

	A	B
17W, 20W, 24W	24 3/4	16
32W, 40W, 54W	48 3/4	24

DAMP/WET LOCATIONS, INSIDE DRIP PROOF LOW PROFILE FLUORESCENT CEILING FIXTURES



TECHNICAL SPECIFICATION

HOUSING AND END CAPS

Copper-free marine-grade aluminum with an oven-cured polyester powder coated white high gloss protective finish.

GUARD

Stainless steel wire guard available.

OUTLETS

All units are supplied blank unless otherwise specified.

GASKETS

Closed cell neoprene gasket covers the entire end and sides sealed against the diffuser.

LAMPHOLDER

Twist and lock lampholders provide resistance to shock and vibration.

BALLAST

All fixtures are supplied rated to operate on 120v AC 60Hz as standard.

LAMP TYPE

Suitable for 2 x 17w T8, 2 x 20w T12, *2 x 24w T5, 2 x 32w T8, 2 x 40w T12, or *2 x 54w T5 fluorescent lamps dependent on type. All fixtures are supplied without lamps.

* Approvals pending.

LENS

A wrap around impact resistant extruded acrylic lens is provided as standard.

ORDERING REFERENCES

DRIP PROOF FLUORESCENT CEILING FIXTURES					SPARE PARTS	
DESCRIPTION	LAMP SIZE	WEIGHT(lbs)	TYPE	SIZE	LAMPHOLDER	
Low Profile Fluorescent	2 x 17w	6.0	FLC217	2 foot	Set of 2 (17/20/32/40w)	FX4036
Low Profile Fluorescent	2 x 20w	7.0	FLC220	2 foot	Set of 2 (24/54w)	FX4065
Low Profile Fluorescent	*2 x 24w	6.0	FLC224	2 foot	BALLASTS	
Low Profile Fluorescent	2 x 32w	9.5	FLC232	4 foot	2 X 17w	FX5260
Low Profile Fluorescent	2 x 40w	10.5	FLC240	4 foot	2 x 20w	FX5001
Low Profile Fluorescent	*2 x 54w	9.5	FLC254	4 foot	2 x 24w	FX5307
					2 x 32w	FX5260H
					2 x 40w	FX5004
					2 X 54W	FX5305
					LENSES	
					2' Clear	FX2016
					2' White	FX2018
					4' Clear	FX2017
					4' White	FX2019
					GUARDS	
					2 foot	FX1008
					4 foot	FX1007

* Approvals pending.