

FEATURES

- ▼ Flush or surface mount types.
- ▼ Single throw double pole snap switches.
- ▼ Choice of corrosion resistant enclosures in heavy wall cast brass.
- ▼ Available in 15 Amp 120v AC, 10 Amp 24v DC, 2 Amp 125v DC, 20 Amp 600v AC, 15 Amp 24v DC or 5 Amp 125v DC dependant on type.
- ▼ 5 year warranty.

APPROVALS

- ▼ ABS
- ▼ Type 4X
- ▼ Conforms to IP 66

APPLICATIONS

- ▼ Marine and wet environments
- ▼ Offshore oil and gas platforms
- ▼ Drill ships and exploration vessels
- ▼ Tankers
- ▼ Ferries/Passenger Ships

DIMENSIONS

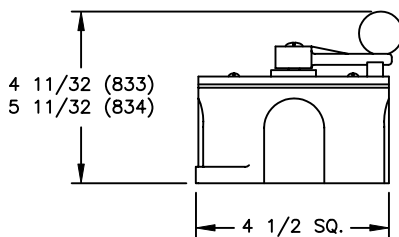
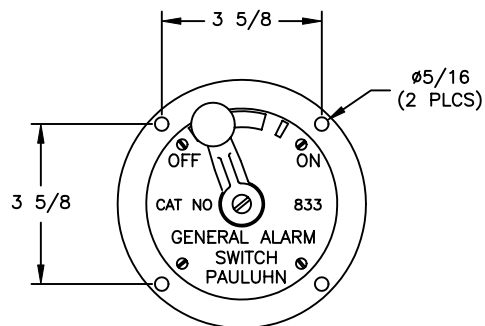
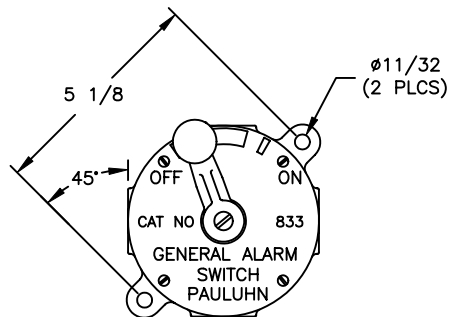

833/834

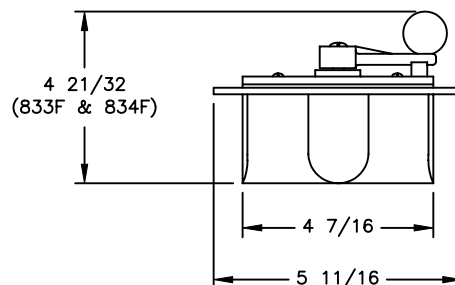

833F/834F

MARINE, OUTSIDE AND CORROSIVE ENVIRONMENTS WATERTIGHT GENERAL ALARM CONTACT MAKER



TECHNICAL SPECIFICATION

HOUSING

Heavy wall cast brass with a natural finish.

HARDWARE

Stainless steel for all types.

OUTLETS

All units are furnished blank but can be supplied with up to four ³/₄" NPT outlets. Please state requirements on application.

SWITCHES

Both units have double pole single throw switches which are spring loaded.

VOLTAGE OPERATION

833 unit is rated for operation on 15 Amp 125v AC, 10 Amp 24v DC or 2 Amp 125v DC. The 834 unit is rated for operation on 20 Amp 600v AC, 15 Amp 24v DC or 5 Amp 125v DC.

MOUNTING

Surface mount units are mounted via two ¹¹/₃₂" Ø mounting holes. Flush mount units are mounted via four ⁹/₃₂" Ø mounting holes.

ORDERING REFERENCES

WATERTIGHT GENERAL ALARM CONTACT MAKER

DESCRIPTION	WEIGHT (lbs)	BRASS TYPE (B)
15 Amp 120v AC Surface Mount 3 Wire	5.0	833
20 Amp 600v AC Surface Mount 3 Wire	6.0	834
15 Amp 120v AC Surface Mount 3 Wire	5.0	833F
20 Amp 600v AC Surface Mount 3 Wire	6.0	834F

SPARE PARTS

BOXES 833 Surface Mount INX6037B 834 Surface Mount INX6083B 833F Flush Mount INX6053B 834F Flush Mount INX6054B	INTERIORS 833 INX3058 834 INX3118-EP
HANDLE INX8017B	COVER WITH HANDLE INX6576B
COVER GASKET GKT3002	"O" RING GKT1041