

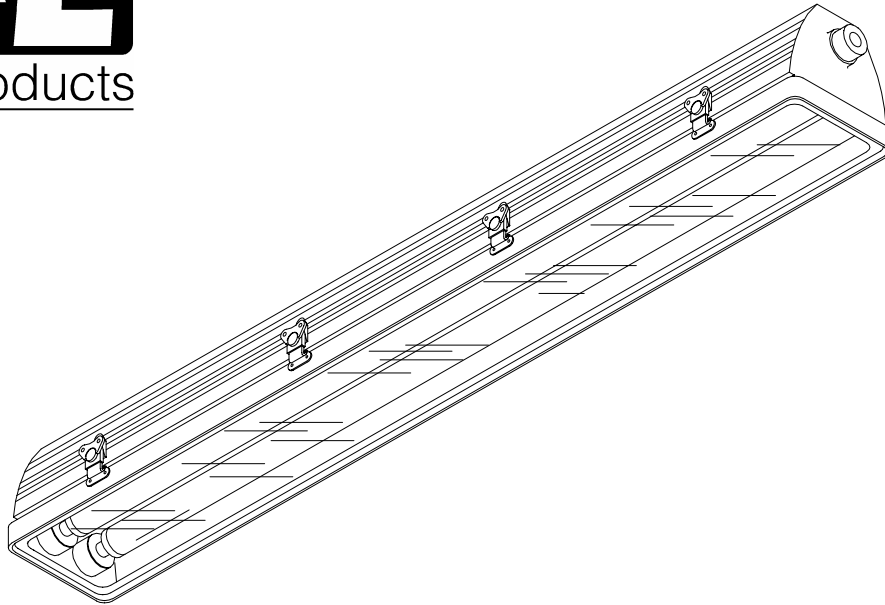

- CSA - Class I Div. 2 - Groups A, B, C, & D
- CSA - Class I Zone 2 - Groups IIA, IIB & IIC
- CSA - Class II Div. 2 - Groups F & G
- CSA - Type 3
- UL 844 - Class I Div. 2 - Groups A, B, C, & D
- UL - Outdoor Marine Type (Salt Water)
- Meets Coast Guard Specifications (USA & Canada)



DuraPro

Hazardous Area Fluorescent

Features:

- **High impact and vibration resistant.**
- Streamline **extruded aluminum housing** with cast end caps.
- **Extruded aluminum reflector** finished with a **high reflectance** baked white enamel.
- **Extruded aluminum lens frame**, seam welded around lens.
- Standard clear high impact **acrylic lens** (optional clear polycarbonate lens).
- **Neoprene gasket** permanently mounted in lens frame.
- Lens **frame hinged** on side for easy lamp replacement (no loose pieces).
- **Spring loaded sockets** on HO models.
- **Locking sockets** on RS models made of industrial grade **high temperature PBT**.
- **Sharp cut off** (60 degrees) 120 degree total lumen distribution.
- Fixture can be rotated 360 degree on longitudinal axis for **optimum light positioning**.
- **2 & 4 foot models** with 1 & 2 lamp T8 or T12 designs.
- **Compact fluorescent** 2 lamp, 2 foot & 4 lamp, 4 foot models.

Applications:

- | | |
|---------------------------|-----------------------------|
| ■ Oil drilling rigs | ■ Marine loading terminals |
| ■ Water treatment plants | ■ Processing plants |
| ■ Bulk storage facilities | ■ Pipeline pumping stations |
| ■ Lubrication pits | ■ Paint storage areas |



DuraPro

Catalog Number Logic

DP **4** - **2** **1** **1** **0** **U** - ******
(1) (2) (3) (4) (5) (6) (7) (8)

(1) Series - DuraPro “DP”

Extruded aluminum housing & door frame,
cast end caps & acrylic lens.

(2) Length (nominal)

2 - 2 foot
4 - 4 foot

(3) Number of Lamps

1 - For 1 lamp
2 - For 2 lamps
4 - For 4 lamps (4 foot unit, ballast type 2 only)

(4) Ballast Type

1 - 265 mA, T8
(0° F & -18° C starting temp, 50/60Hz electronic ballast)
2 - 270 mA, 2G11 - compact fluorescent
(0° F & -18° C starting temp, 50/60Hz electronic ballast)
4 - 430 mA, T12, RS
(+50° F & +10° C starting temp, magnetic ballast)
8 - 800 mA, T12, RS, HO
(-20° F & -29° C starting temp, magnetic ballast)

(5) Voltage / Frequency

1 - 120 Volt 60 Hz.
2 - 220 Volt 50 Hz. (T12 magnetic only, not CSA listed)
3 - 220 to 240 Volt 50/60 Hz. (ballast types 1 & 2 only)
4 - 240 Volt 60 Hz. (T12 magnetic only)
5 - 277 Volt 60 Hz.
6 - 347 Volt 60 Hz. *
7 - 120 to 277 Volt 50/60 Hz. (ballast type 1 only)

(6) Mounting Style

0 - End mounting, standard design.
(brackets required see mounting options)
7 - NRL 1057 back mount

(7) Labels

U - UL
C - CSA (C/US)
M - Dual labels (UL & CSA)

(8) Special Options

EM1 - Emergency ballast, all areas, 700 lumen*
L - Lamps (energy saving except on HO)
P - Polycarbonate lens (clear)
R - Oilfield model consisting of:
1 - 1/2" npt. hub & 1 - hook for safety cable.
(see mounting accessories for safety cable).
1 - DP1053MTK mounting kit.
2 - Standard HO Lamps. (installed)
S - Switch, on/off *

Notes:

1. Lamps are not included, unless “R” option is ordered.
2. All emergency units have integral test switch and charging circuit indicator lamp.
3. * CSA (C/US) approved only.
4. Consult factory for any catalog number or options not listed above for price and availability.

DuraPro

Ordering Guide

Standard Models 120V 60 Hz (Lamps & Required Mounting Brackets Not Included)

Fixture Length	Ballast Type	Lamp Type	No. of Lamps	Raw Lumen Output	Voltage	Catalog Number
Two Foot	Electronic	F17T8	2	2,502	120V - 60Hz	DP2-2110C
		FT40W/2G11	2	6,300		DP2-2210C
	Magnetic	F24T12/HO	2	2,689		DP2-2810C
Four Foot	Electronic	F32T8	2	6,962		DP4-2110C
		FT40W/2G11	4	12,600		DP4-4210C
	Magnetic	F40/ES	2	4,770		DP4-2410C
		F48T12/HO	2	6,885		DP4-2810C

Rig Models (C/W Lamps ,Brackets and options as per ordering guide)

Two Foot	Electronic	F17T8	2	2,502	120V - 60Hz	DP2-2110C-R
	Magnetic	F24T12/HO	2	2,689		DP2-2810C-R
						DP2-2810C-R2
						DP2-2817C-R
	220V-50Hz	DP2-2820U-R				
Four Foot	Electronic	F32T8	2	6,962	120V - 60Hz	DP4-2110C-R
	Magnetic	F48T12/HO	2	6,885		DP4-2810C-R
						DP4-2810C-R2
						DP4-2817C-R
	220V-50Hz	DP4-2820U-R				

Notes: Catalog number shown is for feed-thru design. (fixture is c/w two 1/2" npt. hubs).

For mounting style "7" (back mount) change last number "0" to "7"

* Add "C" for CSA (C/US), "U" for UL listed, "M" for both labels.

Certification Guide

Magnetic ballast approved for 40 degree C ambient Electronic ballast approved for 55 degree C ambient		Class I Div. 2 Groups A, B, C & D		Class I Zone 2 Groups IIA, IIB & IIC		Class II Div. 2 Class III	
Ballast Type	No. of Lamps	Approval	T-Rating	Approval	T-Rating	Approval	Groups
Electronic, 265mA, T8, RS	1 & 2	CSA/UL	T5	CSA	T5	CSA	F & G
Electronic, 270mA, 2G11, RS	2 & 4	CSA	T5	CSA	T5	CSA	F & G
Magnetic, 430mA, T12, RS	1 & 2	CSA/UL	T5	CSA	T5	CSA	F & G
Magnetic, 800mA, T12, HO	1 & 2	CSA/UL	T4A	CSA	T4	CSA	F & G

For detailed test results and approvals consult factory

DuraPro

Dimensions

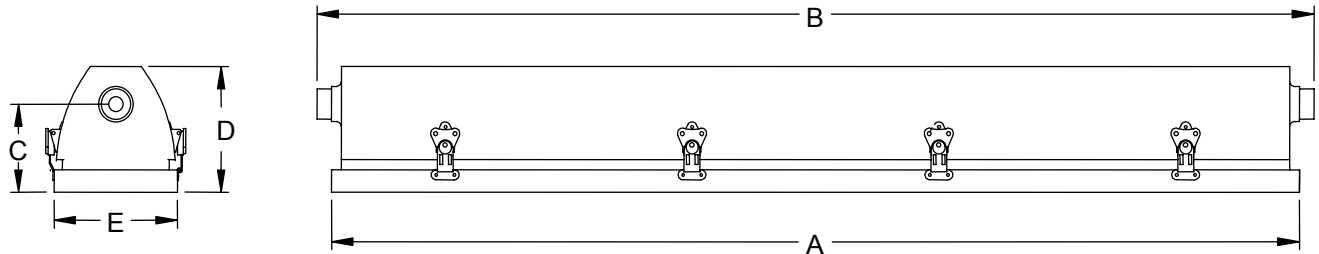

Nominal Length	Dimensions in Inches / Centimeters					Cubic Size Feet / Meter	Weight lb. / kg
	A	B	C	D	E		
2 Foot	26.0 / 66.0	27.6 / 70.2	4.4 / 11.1	6.3 / 16.0	6.5 / 16.5	0.78 / 0.02	23.0 / 9.64
4 Foot	50.0 / 127.0	51.6 / 131.1	4.4 / 11.1	6.3 / 16.0	6.5 / 16.5	1.55 / 0.04	32.0 / 14.55

Weights shown are for HO models
Deduct 5 lbs. / 2.2 kg. for all other ballast types

Mounting Options

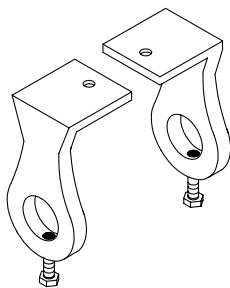

DP1053MTK
Standard ceiling / wall mounting kit.
Consisting of 2 aluminum brackets.

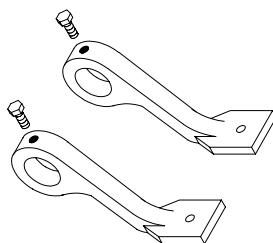
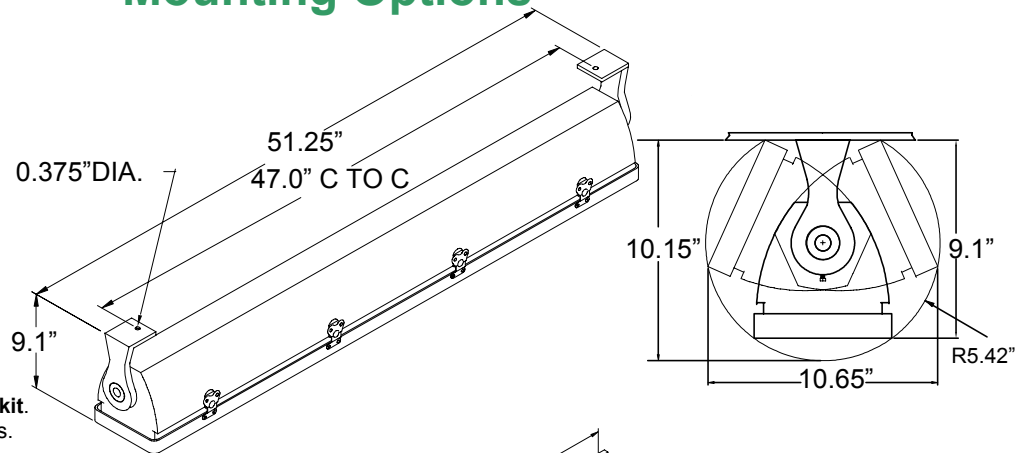

DP1052MTK
Wall mounting kit.
Consisting of 2 aluminum brackets.

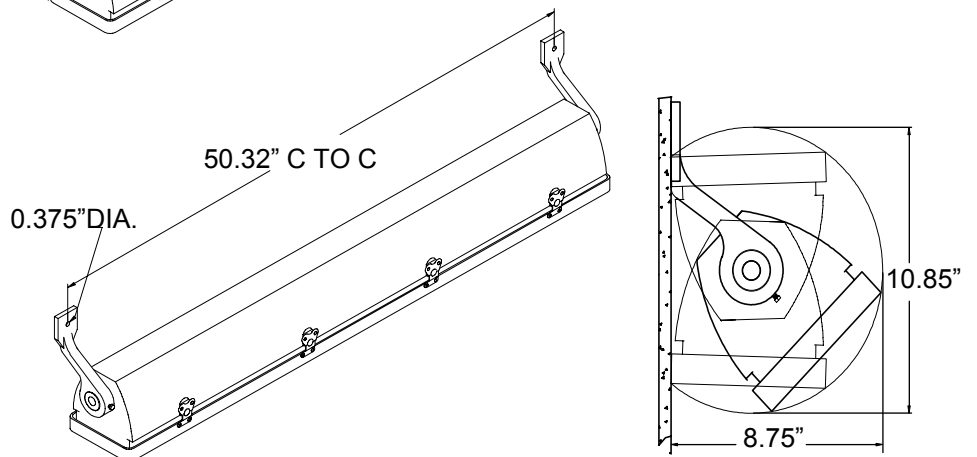

DuraPro

Mounting Options

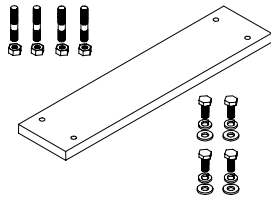

Back Mount style "7"
Must be ordered installed on fixture
Factory Installed. See Catalog Logic.

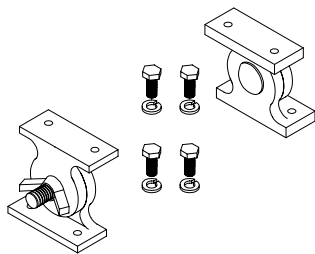
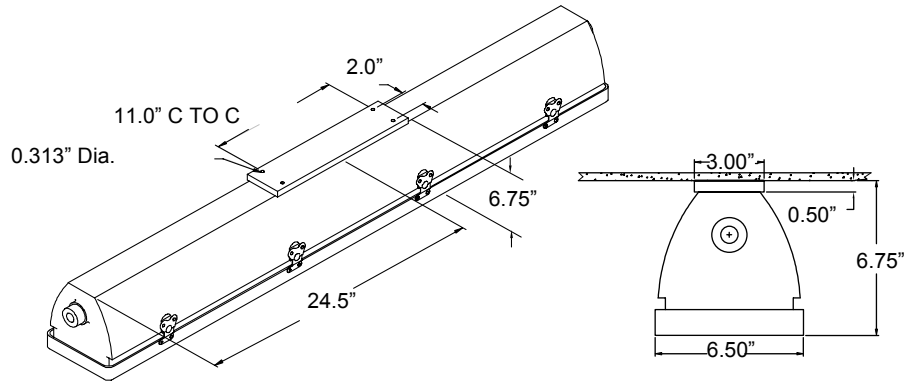

DP1051MTK
Back Mount swivel kit.
Available for style "7" back mount only.

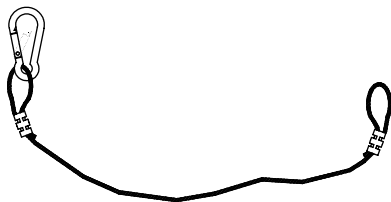
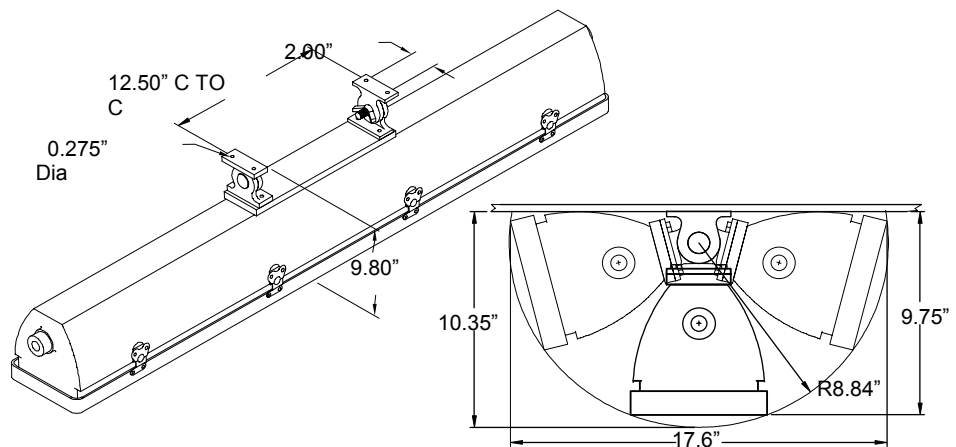

#SC30H
30" Safety cable C/W snap hook.
For use with fixtures that include eyebolt or
factory installed eyelet.

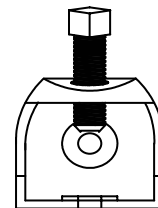
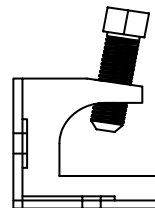

1.125" Jaw opening
0.3125" Mtg holes
1/2" Set Screw

#BC2K
Beam clamp kit. (2 pcs.)
Used with end mounting style brackets

DuraPro

Parts List

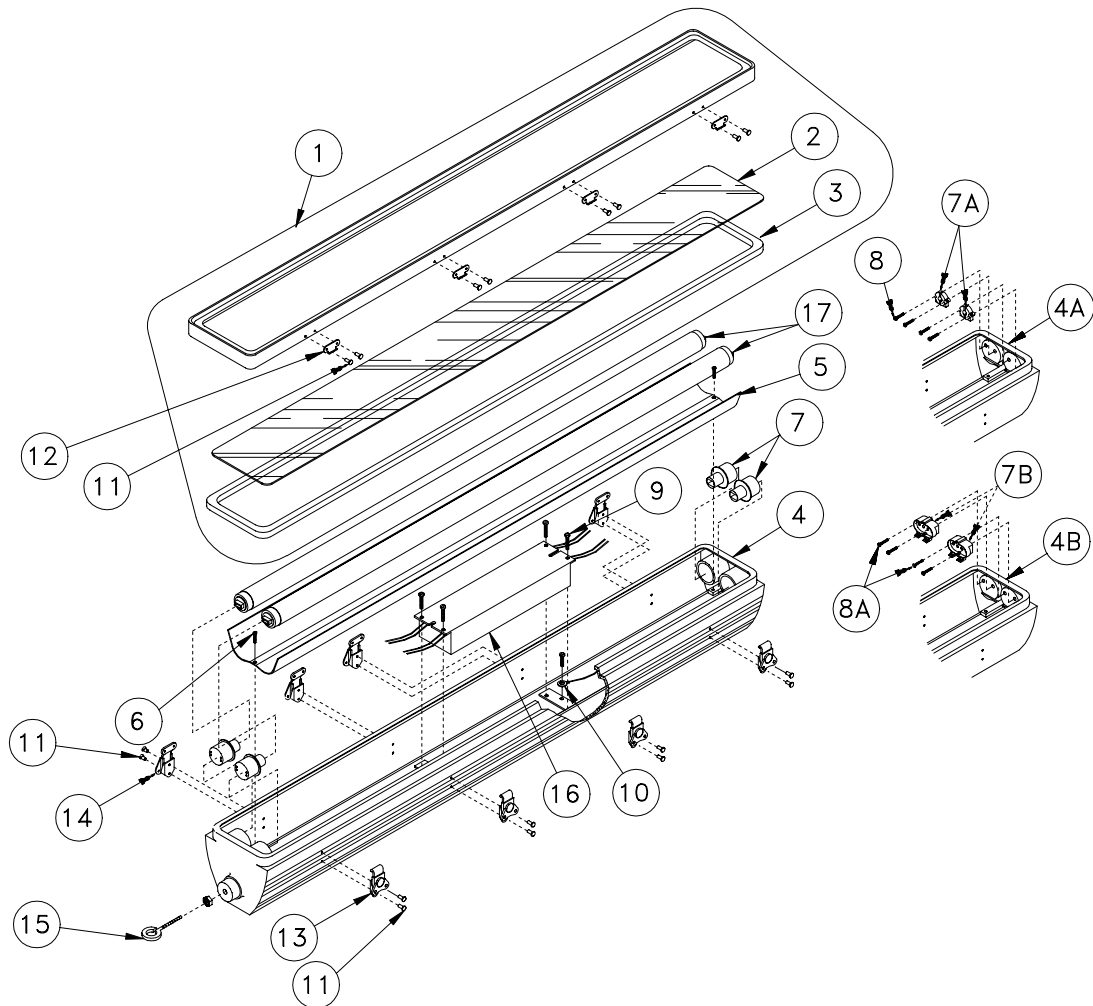

Item No.	Part No.	Description	No Req'd	Item No.	Part No.	Description	No Req'd
1	003-4000	Door frame assembly for all 4 ft. models	1	6	309-1005	Screw, reflector mounting for all models	2
1*	003-2000	Door frame assembly for all 2 ft. models	1	7	758-0523	Socket, RDC, spring loaded for all HO models	4
2	003-4100	Lens, acrylic for all 4 ft. models	1	7A	754-7102	Socket, Bi-pin, for all T8 / T12 models	4
2*	003-2100	Lens, acrylic for all 2 ft. models	1	7B	752-6051	Socket, 2G11 type, for all CF models	2 or 4
3	003-4200	Gasket, neoprene for all 4 ft. models	1	7*	752-5766	Support, lamp, for all 2G11-CF models	2 or 4
3*	003-2200	Gasket, neoprene for all 2 ft. models	1	8	309-0404	Screw, socket mounting for T8 / T12 models	8
4	003-4808	Housing for 4 ft., HO model	1	8A	309-0402	Screw, socket mounting for 2G11-CF models	4 or 8
4A	003-4804	Housing for 4 ft., T8 / T12 model	1	9	380-1006	Mounting hardware, ballast for all models	2 / 4 sets
4B	003-4802	Housing for 4 ft., 2G11-CF model	1	10	380-1435	Grounding hardware assembly for all models	1 set
4*	003-2408	Housing for 2 ft., HO model	1	11	035-1067	Rivet, closed end, for all models	16 or 32
4*	003-2404	Housing for 2 ft., T8 / T12 model	1	12	035-1064	Keeper plate for all models	2 or 4
4*	003-2402	Housing for 2 ft., 2G11-CF model	1	13	035-1065	Catch lock for all models	2 or 4
5	003-4300	Reflector for 4 ft., HO model	1	14	035-1066	Hinge lock for all models	2 or 4
5*	003-4310	Reflector for all 4 ft. models, except HO	1	15	103-1061	Eyebolt & nut for HO model (to attach opt. SC30H)	1 set
5*	003-2300	Reflector for 2 ft., HO model	1	16		Ballast (see ballast chart page for type)	1 or 2
5*	003-2310	Reflector for all 2 ft. models, except HO	1	17		Lamps (see lamp chart page for type)	2 or 4

* Item not shown on drawing