

# Unlighted Steel Buoys Can Type

## Buoy Classification

BC-3 — Third Class

BC-4 — Second Class

BC-5 — First Class

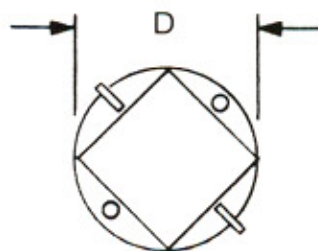

### Specifications:

BC-3

BC-4

BC-5

#### Dimensions:

A	8'0"	13'6"	18'3'
B	3'9"	6'0"	7'9"
C	4'3"	7'6"	10'6"
D	3'0"	4'0"	5'0"

#### Recommended Moorings

Anchor, concrete	3,000 lbs.	4,000 lbs.	5,000 lbs.
Chain	3/4"	1 1/8"	1 1/8"

#### Body Material

Steel Steel Steel

#### Day Mark

12 3/4 ft.<sup>2</sup> 30 ft<sup>2</sup> 52 1/2 ft.<sup>2</sup>

Buoys can be filled with buoyant foam

Weight less moorings	875 lbs.	2,565 lbs.	5,150 lbs.
Reserve buoyancy	1,254 lbs.	3,216 lbs.	7,560 lbs.
Pounds/Inch Immersion	38 lbs./in.	67 lbs./in.	105 lbs./in.
Freeboard (to top of can)	33"	48"	72"

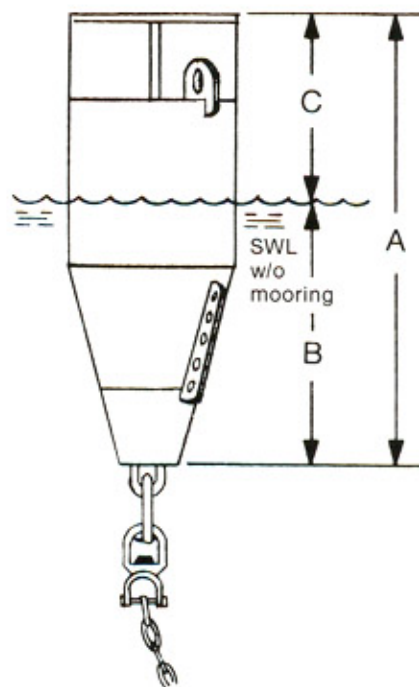

**Note:** Standard buoy does not include mooring.

Steel buoys standard finish: sand-blast outside after fabrication, Di-metcote Coating; one intermediate coat, and one vinyl color coat.



**Automatic Power Inc**

# Unlighted Steel Buoys Nun Type

## Buoy Classification

- BN-3 — Third Class
- BN-4 — Second Class
- BN-5 — First Class

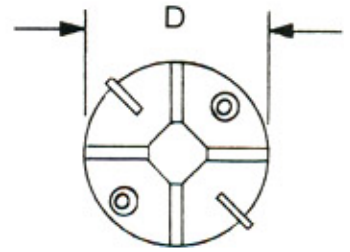

### Specifications:

	BN-3	BN-4	BN-5
<b>Dimensions:</b>			
A	9'0"	14'6"	19'9"
B	3'9"	5'11"	7'6½"
C	5'3"	8'7"	12'2½"
D	3'0"	4'0"	5'0"
<b>Recommended Moorings</b>			
Anchor, concrete	3,000 lbs.	4,000 lbs.	5,000 lbs.
Chain	¾"	1⅛"	1⅛"
<b>Body Material</b>	Steel	Steel	Steel
<b>Day Mark</b>	13.25 ft. <sup>2</sup>	27½ ft. <sup>2</sup>	49 ft. <sup>2</sup>
Buoys can be filled with buoyant foam			
<b>Weight less moorings</b>	865 lbs.	2,465 lbs.	4,875 lbs.
<b>Reserve buoyancy</b>	1,254 lbs.	3,283 lbs.	7,822 lbs.
<b>Pounds/Inch Immersion</b>	38 lbs./in.	67 lbs./in.	105 lbs./in.
<b>Freeboard (to top of can)</b>	33"	49"	74½"

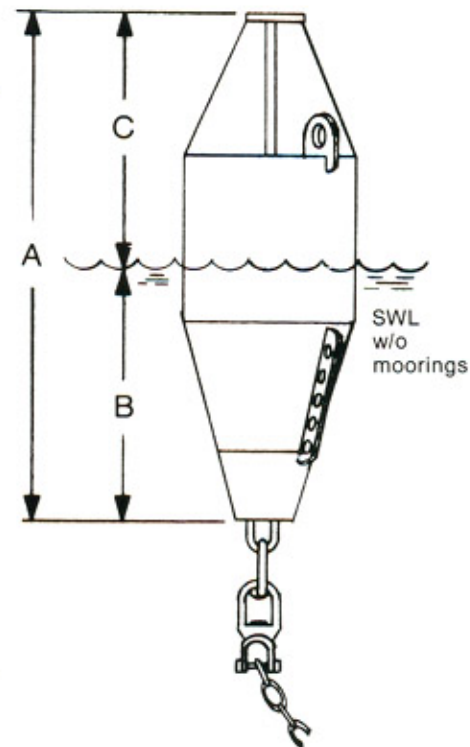

**Note:** Standard buoy does not include mooring.

Steel buoys standard finish: sand-blast outside after fabrication, Di-metecote Coating; one intermediate coat, and one vinyl color coat.